

**PUD NO. 1 OF SKAGIT COUNTY  
ALTA VISTA, VISTA VIEW AND PLAZA DRIVE PROJECT  
ADDENDUM NO. 1**

Date of Issue: August 5, 2025

**To All Planholders and/or Prospective Bidders:**

**The time and place of bidding remains unchanged** as 10:00 AM, Tuesday, August 12, 2025, at Public Utility District No. 1 of Skagit County.

Acknowledge receipt of this Addendum in the space provided in the BID FORM. Failure to do so may subject the Bidder to disqualification.

The following changes, additions, and/or deletions are hereby made part of the project bid documents for the Alta Vista, Vista View and Plaza Drive Project, and shall have the same effect as if set forth therein.

**A. GENERAL:**

- a. A pre-bid meeting was held on August 4, 2025. Meeting minutes and a list of attendees are attached to this addendum.

**B. PLANS:**

- a. Remove Sheets 5 & 8-12
- b. Insert attached sheets 5 & 8-12 showing additional restrained lengths of pipe as discussed in the pre-bid meeting.

**C. SPECIFICATIONS:**

Clarifications:

- Restrained Joints:
  - a. Mechanical joint restraints shall be ring type restraints such Star Uni-ring, Midland Manufacturing Perma Grip, or equal.
  - b. Bell and spigot restrained joints shall be shackle type restraints, no bell and spigot gasket joint restraints will be allowed.
  - c. Typical restrained lengths shall include a joint restraint at the valve and 3 bell and spigot shackle restraints attached to four (4) full lengths of pipe (20 feet) for a total of eighty (80) feet of restrained pipe in each direction. Shackle restraints require Denso or wax tape wrapping.
- Trench Backfill:
  - a. All trench backfill is required to be imported structural fill.
  - b. The PUD has not performed any geotechnical analysis to determine if the existing soil on site is acceptable as structural backfill that may be salvaged. In the event the existing soil is usable as backfill and permitted by Skagit County, the PUD will seek a reduction in price in accordance with 1-04.4(2) of WSDOT Standard Specifications for Road and Bridge Construction.
- Saw-cutting/Grinding:
  - a. Skagit County requires 1-foot of pavement removal beyond each side of the trench limits prior to paving. The suitability of the clean edge of this removed pavement is at the discretion of Skagit County. Cutting or grinding this edge at the time of pavement removal and not immediately prior to paving will require preservation of the edge and acceptance of the County as a suitable face for new pavement to attach.

D. RESPONSES TO QUESTIONS:

Question	Response
We will be supplying materials for this project and would like conformation that no "Only Domestically made materials" example, Buy America or American, BABA act, AIS, etc. requirements exist within the above project?	There are no 'only domestically made materials' requirements for this project.
The Air Vac assembly appears to be in a grass area, but close to the street. Will that need to be a UV 3030-LA vault or a plastic Carson 1730 Box?	A Carson 1730 is an acceptable alternative.
Will the contractor be required to provide traffic control on Hwy 20, when the PUD is performing their work with the new 2" line? The note on sheet 12 doesn't address that specifically.	The contractor will not be responsible for traffic control to support PUD work along SR20, except for tie-ins.

This Addendum consists of these two pages, two pages of minutes, two pages of attendance sheet, and six pages revised plans, for a total Addendum of **twelve (12) pages**.

Mark C. Handzlik, P.E., Engineering Manager  
PUD No.1 of Skagit County

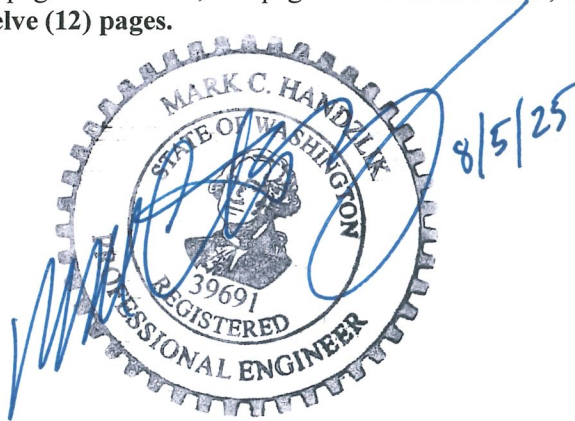



**Alta Vista, Vista View and Plaza Drive Project  
Pre-Bid Meeting Minutes  
August 4, 2025**

Josh Brady, Engineering Technician, called the meeting to order at 10:00 a.m.

Engineering Technician Brady opened the meeting with Skagit PUD staff introductions.

He discussed the purpose of the Pre-Bid to briefly go over the project and to provide an opportunity for Bidder questions/answers.

Engineering Technician Brady provided a brief project description/overview including, installation of approximately 3,500 linear feet of 8-inch PVC water distribution piping along Alta Vista Drive, Vista View Drive, and Plaza Drive in Skagit County, including fittings, thrust blocks, service connections, fire hydrants, branch and mainline valves, establishment of private water service, dewatering, appurtenances and incidentals, pavement repair, abandonment of existing valves in place, temporary traffic control, temporary erosion control, disinfection, and pressure testing, in estimated quantities identified in the Bid Proposal and as shown on the plans. Engineering Technician Brady reviewed plan sheet # 13 stating that there is an additional 500 LF of 2-inch pipe along State Route 20 that PUD's crew will be doing in conjunction with the project. Tie-ins will need to be coordinated closely during this time.

Engineering Technician Brady reviewed the following Bid Schedule:

Question Cutoff: August 8, 2025, at end of day

Bids Due: August 12, 2025, at 10:00 AM

Open Bids: August 12, 2025, no sooner than 10:01 AM

Anticipated Award Date: Wednesday, August 27, 2025

Pre-Construction Meeting: week of September 15, 2025

Estimated Notice to Proceed issued: middle to end of September 2025

Estimated Completion of Construction: end of November 2025

Engineering Technician Brady noted project constraints including Inadvertent Discovery Plan, no known recorded discoveries. Traffic Control (Permits Appendix A): Skagit County permit for County detour, permit not yet acquired; and WSDOT General Permit for TC on SR-20. Engineering Manager Handzlik stated that the Skagit County permit will be issued via addenda if it is received in time, if not, bid as planned. Dewatering is to be included and will be paid for in the individual pay items as described in Section 01025 – Measurement and Payment. Incidental dewatering covers basic dewatering techniques like trash pumps and minimal dewatering. Should significant dewatering be required, such as well points, this would be considered a change of condition, and the project would be abandoned, or a change order would be instituted to cover extraordinary dewatering efforts. Work hours and days: 7 AM to 9 PM, Monday through Friday, and 8 AM to 9 PM, Saturday and Sunday, unless changed via the approved ROW permit provisions. Lastly, 75 consecutive calendar contract days. Scheduling Constraints include paving window (around November 15), PUD crew tie-ins (three-day advance notice), and owner supplied materials.

Engineering Technician Brady reviewed a few Bid Schedule Items: Item no. 6 - Traffic control– LS; Item no. 30 - Tie-in sheet 9– Work in conjunction with PUD crew's project (sheet 13); and Item no. 33 - Force account fence and landscape repair. He reviewed the fencing and landscaping on sheets 11 and 12.

Engineering Technician Brady reviewed Bid/Proposal Issues. Use only the Bid Proposal form or Addendum Bid Proposal form to submit bids. All pages of the form must be submitted with bid unless

specific addenda pages are issued. Include the Addenda Acknowledgement form. If bid items or quantities are revised, a new Bid Proposal form will be issued.

Engineering Technician Brady stated that the typical cut off for Monthly payments is on the 25<sup>th</sup> of the month. There is 5% retainage held on this project.

He reviewed miscellaneous items such as the Contractor is required to work continuously, mailboxes are incidental, and customers must be able to get in and out of their driveways.

Engineering Technician Brady announced that Addendum No. 1 will be issued including minutes and questions/clarifications from this pre-bid meeting.

Engineering Technician Brady asked if there were any Questions/Clarifications at this time.

- The location of the line is outside of the pavement. PUD does not have a geotechnical report. The Contractor can test the soils. It is possible that the excavated material can be used for backfilling. In that case, Skagit PUD would share the cost savings as value engineering. The County wants “structural backfill”; therefore, bid it that way.

Q Is the Contractor to sawcut or use a grinder?

A Skagit County requires a 1-foot additional sawcut edge for paving. It will be up to Skagit County’s discretion to allow the ground edge instead of saw-cutting. Cutting or grinding this edge at the time of pavement removal and not immediately prior to paving will require preservation of the edge and acceptance of the County as a suitable face for new pavement to attach.

- All PVC0 is to be thrust blocked, not restrained joints. Valves can use a ring type mechanical restraint and pipe bells and spigots are to be shackled restraints (four full length pipes in each direction) and be Denso or wax tape wrapped. Restrained length shall be 80-foot total. Four full 20-foot lengths of pipe, one restraint at the valve and 3 shackle restraints at bell and spigot joints. Thrust blocks may be premanufactured.

With nothing further to discuss, the prebid meeting was adjourned at 10:17 a.m.

Respectfully yours, Catherine Price



Alta Vista, Vista View and Plaza Drive Project  
 Pre-Bid Meeting  
 August 4, 2025  
 10:00 AM

PRINT NAME	COMPANY	PHONE	E-MAIL
Catherine Price	PUD	960-848-4472	Price@SkagitPUD.org
Mark Handzlik	PUD		Handzlik@SkagitPUD.org
Josh Brady	PUD		Brady@SkagitPUD.org
<del>Chris Smith</del>	<del>PUD</del>		<del>Smith@SkagitPUD.org</del>
Kerry Nesso	"	360-641-4065	Nesso@SkagitPUD.org
Michelle Peters	PUD	360 899 6175	Peters@stacydud.org
MARKER BLANTON	11111	360 333 8360	Kaaling@firecompares.com
Stephen Moe	EVS	425-320-9709	Steve M@Earth Solutions
Nick Wylie	Excavation West	360-814-3431	Nick@Excavationwest.com
Nolan Swartz	Excavation West	360-890-5327	nolan@Excavationwest.com
Elisabeth Faussett	Bill Buckhoe Inc	425-422-4433	dg.buckhoe@fonter.com
Mark Semrau	PUD		
Chris Browns	LARRY BROWN CONST. INC	360.966.7206	LBROWN@BC@gmail.com

Alta Vista, Vista View and Plaza Drive Project  
 Pre-Bid Meeting  
 August 4, 2025  
 10:00 AM

PRINT NAME	COMPANY	PHONE	E-MAIL
James Schroeder	Iconix Materials	360-644-4272	Jschroeder@iconix.com
Richard Gango	Valdez Construction	425 463 5829	rvnrgo@valdeco.com
Alistair Bowdreau	PUD		



- NOTES:
- CONTRACTOR TO EXPOSE ENTIRE EX. METER BOX AND SETTER FOR DISTRICT CONNECTIONS.
  - CONTRACTOR TO POT HOLE EX. TO ESTABLISH LINE AND GRADE FOR CONNECTIONS
  - CONTRACTOR RESPONSIBLE FOR ALL EXCAVATION, SHORING, DEWATERING, TRAFFIC CONTROL, CONCRETE THRUST BLOCKING, BACKFILL, COMPACTION, AND SURFACE RESTORATION.
  - ALL LONG SIDE CUSTOMER SERVICE LINES ARE TO BE MOLED/BORED.
  - CONTRACTOR TO PROTECT EXISTING MAILBOXES.

RENEW EX. SERVICES AT:	
STA	ADDRESS
44+28	21292 PLAZA DR.
44+52	21301 PLAZA DR.
45+24	10546 VISTA VIEW DR.
45+45	21309 PLAZA DR.
47+10	21313 PLAZA DR.
47+64	21317 PLAZA DR.
48+03	21316 PLAZA DR.
48+29	21318 PLAZA DR.
48+30	21319 PLAZA DR.

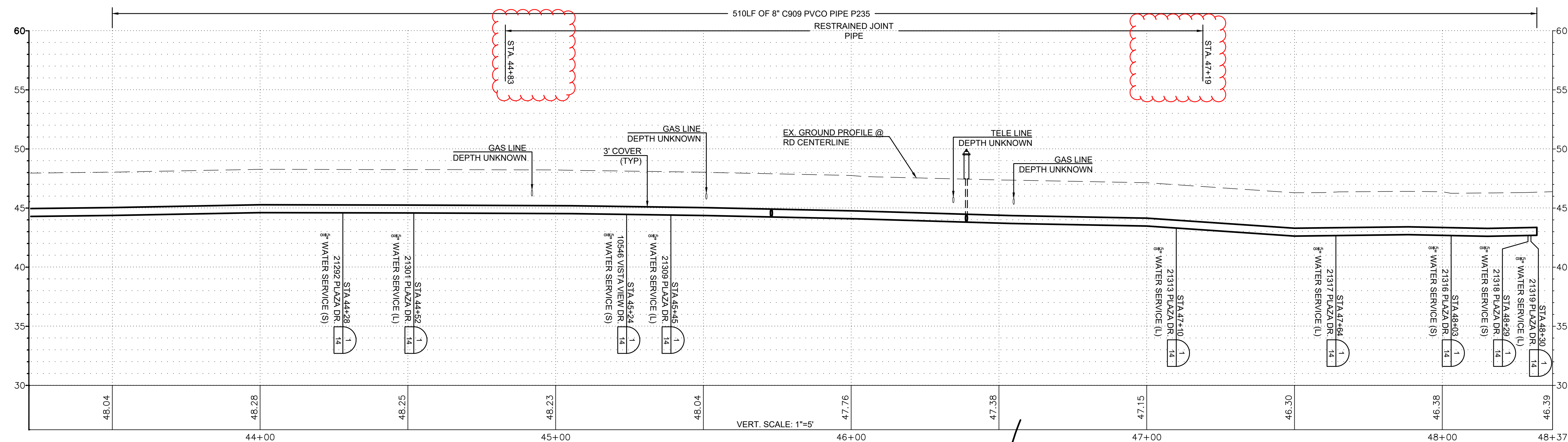
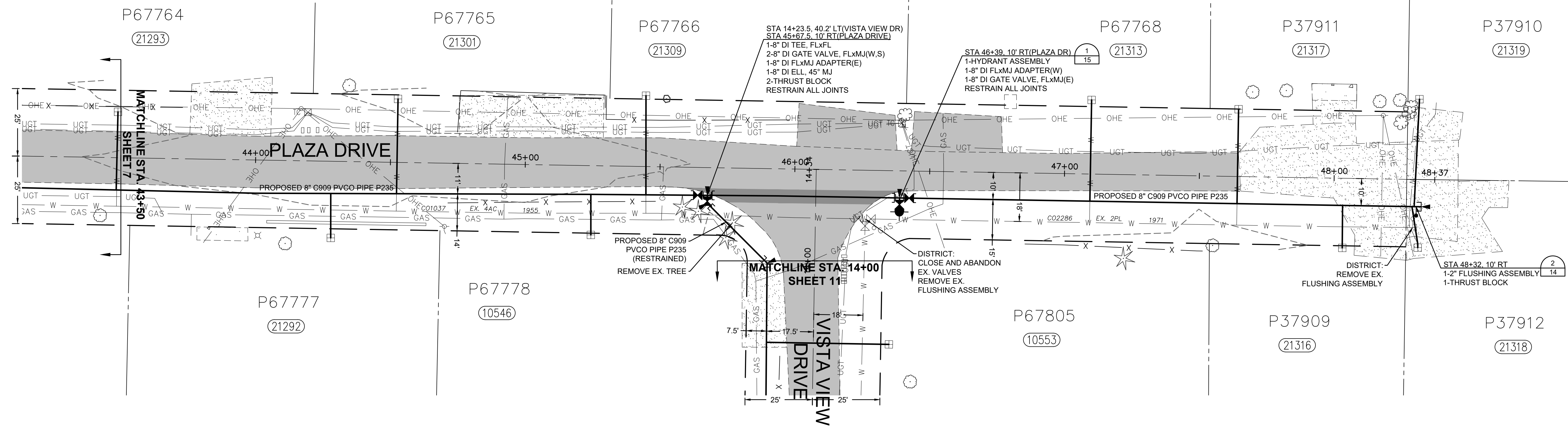

ISSUE	REVISIONS	BY	DATE
1.	30% DESIGN	MCH	4/25/16
2.	90% DESIGN	MCH	12/21/17
3.	ISSUED FOR BIDDING	MCH	7/29/25
4.	ADDENDUM #1	MCH	8/5/25



DATUM:  
HOR: NAD 83  
VERT: NAVD 88

DSGN BY: CAS  
DWN BY: JLB  
APPVD BY: MCH

DATE PRINTED: SEC: 27  
TWP: 35 N  
RGE: 4 E



PUBLIC UTILITY DISTRICT  
NO. 1 of SKAGIT COUNTY  
1415 Freeway Drive  
P.O. BOX 1436  
Mount Vernon, WA 98273  
(360) 424-7104  
www.SkagitPud.org

ALTA VISTA, VISTA VIEW AND PLAZA DR.

PLAZA DRIVE  
PLAN AND PROFILE  
STA 43+50 TO STA 48+37(PLAZA DR)  
STA 14+00 TO STA 14+34(VISTA VIEW DR)

SCALE: 1"=20'

P.N. 16-03632  
C.O. 4926

SHEET:  
8 OF 16

- NOTES:
- CONTRACTOR TO EXPOSE ENTIRE EX. METER BOX AND SETTER FOR DISTRICT CONNECTIONS.
  - CONTRACTOR TO POT HOLE EX. TO ESTABLISH LINE AND GRADE FOR CONNECTIONS.
  - CONTRACTOR RESPONSIBLE FOR ALL EXCAVATION, SHORING, DEWATERING, TRAFFIC CONTROL, CONCRETE THRUST BLOCKING, BACKFILL, COMPACTION, AND SURFACE RESTORATION.
  - ALL LONG SIDE CUSTOMER SERVICE LINES ARE TO BE MOLED/BORED.
  - CONTRACTOR TO PROTECT EXISTING MAILBOXES.

STA	ADDRESS
2+40	10687 VISTA VIEW DR.
3+23	10674 VISTA VIEW DR.
3+31	10673 VISTA VIEW DR.
4+67	10663 VISTA VIEW DR.
4+80.5	10650 VISTA VIEW DR.
5+47	10645 VISTA VIEW DR.
6+19	10636 VISTA VIEW DR.

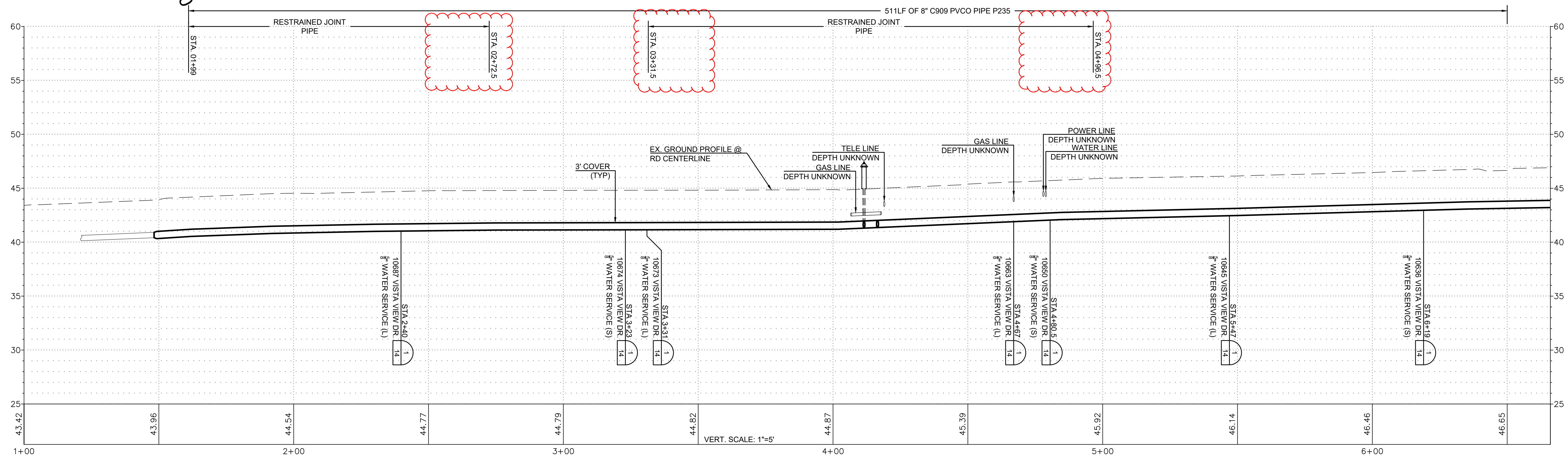
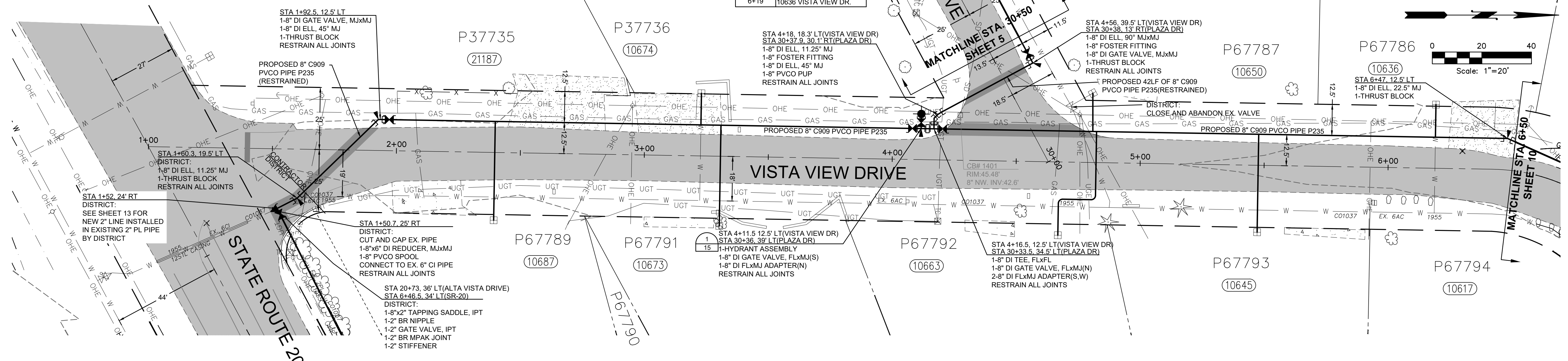

ISSUE	REVISIONS	BY	DATE
1.	30% DESIGN	MCH	4/25/16
2.	90% DESIGN	MCH	12/21/17
3.	ISSUED FOR BIDDING	MCH	7/29/25
4.	ADDENDUM #1	MCH	8/5/25



DATUM:  
HOR: NAD 88  
VERT: NAVD 88

DSGN BY: CAS  
DWN BY: JLB  
APPVD BY: MCH

DATE PRINTED: SEC: 27  
TWP: 35 N  
RGE: 4 E



PUBLIC UTILITY DISTRICT  
NO. 1 of SKAGIT COUNTY  
1415 Freeway Drive  
P.O. BOX 1436  
Mount Vernon, WA 98273  
(360) 424-7104  
www.SkagitPud.org

ALTA VISTA, VISTA VIEW AND PLAZA DR.

VISTA VIEW  
PLAN AND PROFILE  
STA 1+00 TO STA 6+50(VISTA VIEW)  
STA 30+00 TO STA 30+50(PLAZA DR)

SCALE: 1"=20'

P.N. 16-03632  
C.O. 4926

SHEET:  
9 OF 16

- NOTES:
- CONTRACTOR TO EXPOSE ENTIRE EX. METER BOX AND SETTER FOR DISTRICT CONNECTIONS.
  - CONTRACTOR TO POT HOLE EX. TO ESTABLISH LINE AND GRADE FOR CONNECTIONS
  - CONTRACTOR RESPONSIBLE FOR ALL EXCAVATION, SHORING, DEWATERING, TRAFFIC CONTROL, CONCRETE THRUST BLOCKING, BACKFILL, COMPACTION, AND SURFACE RESTORATION.
  - ALL LONG SIDE CUSTOMER SERVICE LINES ARE TO BE MOLED/BORED.
  - CONTRACTOR TO PROTECT EXISTING MAILBOXES.

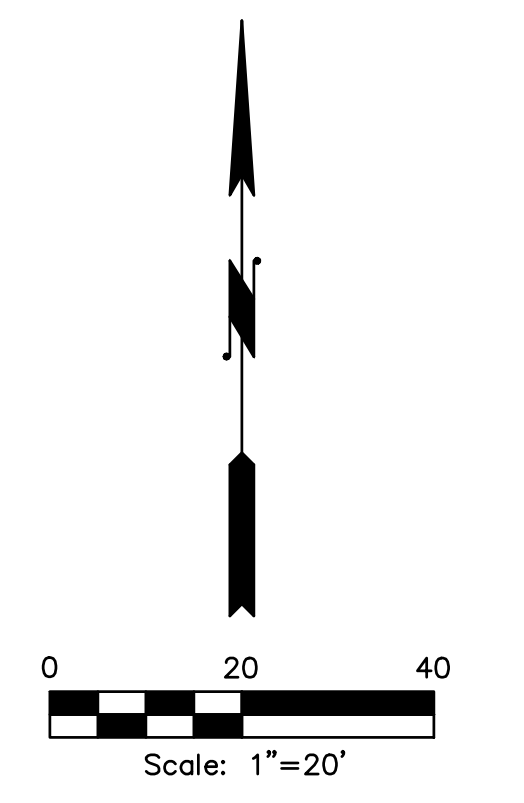
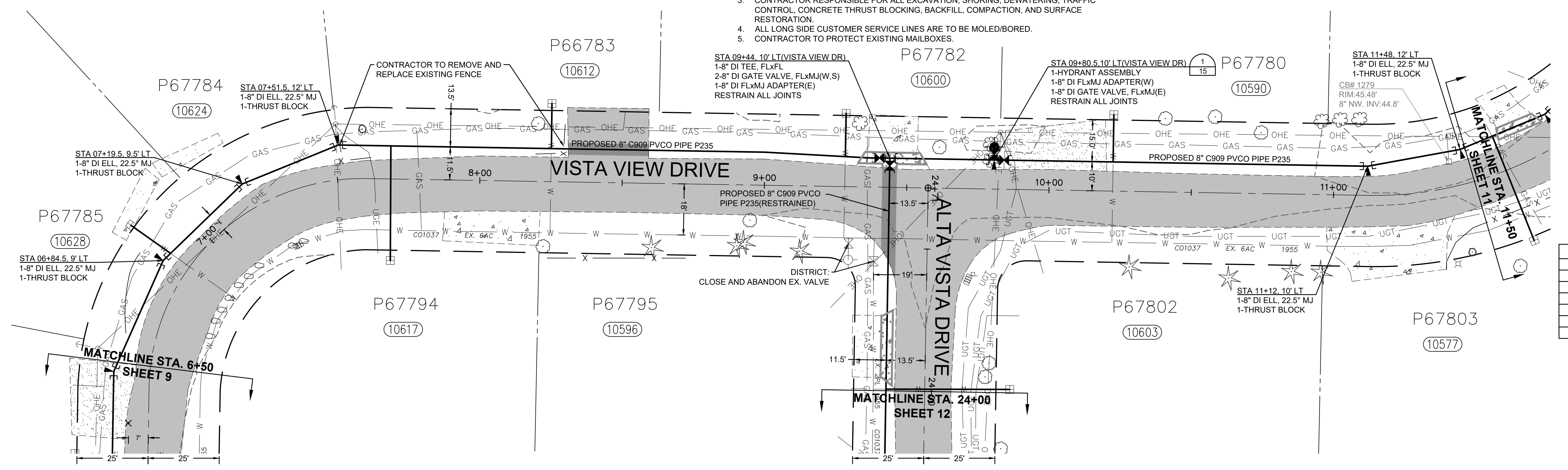

RENEW EX. SERVICES AT:	
STA	ADDRESS
6+88	10628 VISTA VIEW DR.
7+69	10617 VISTA VIEW DR.
8+25	10612 VISTA VIEW DR.
9+28	10600 VISTA VIEW DR.
10+22	10590 VISTA VIEW DR.
24+01	10603 ALTA VISTA DR.

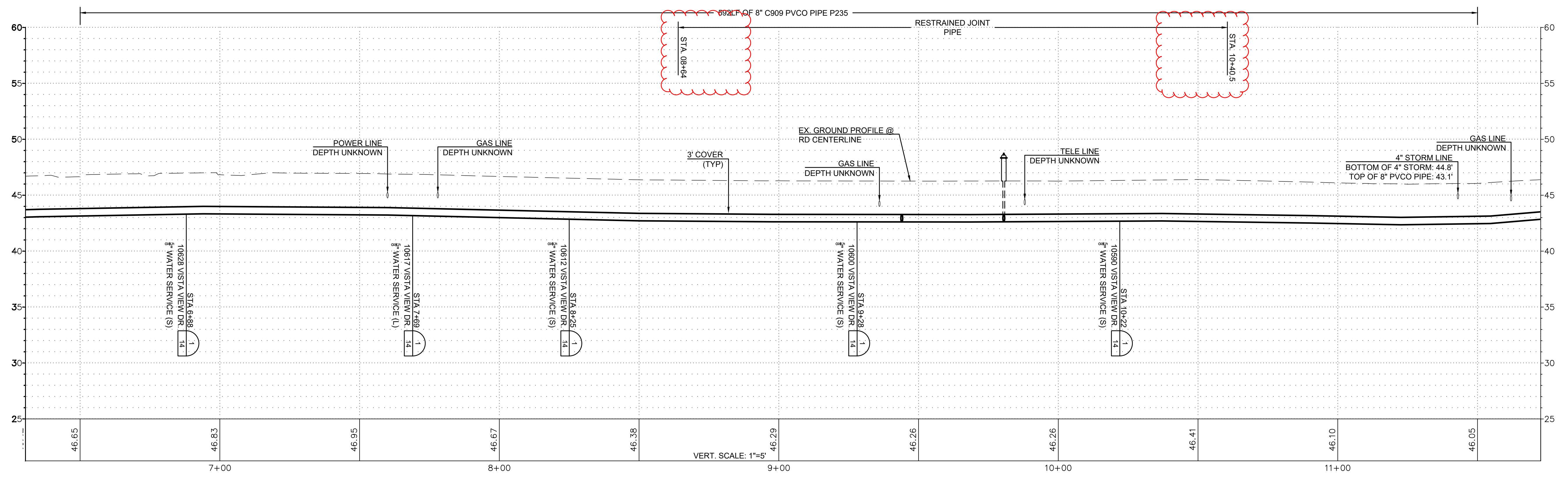

ISSUE	REVISIONS	BY	DATE
1.	30% DESIGN	MCH	4/25/16
2.	90% DESIGN	MCH	12/21/17
3.	ISSUED FOR BIDDING	MCH	7/29/25
4.	ADDENDUM #1	MCH	8/5/25



DATUM:  
HOR: NAD 83  
VERT: NAVD 88

DSGN BY: CAS  
DWN BY: JLB  
APPVD BY: MCH

DATE PRINTED: SEC: 27  
TWP: 35 N  
RGE: 4 E



PUBLIC UTILITY DISTRICT  
NO. 1 of SKAGIT COUNTY  
1415 Freeway Drive  
P.O. BOX 1436  
Mount Vernon, WA 98273  
(360) 424-7104  
www.SkagitPud.org

ALTA VISTA, VISTA VIEW AND PLAZA DR.  
VISTA VIEW  
PLAN AND PROFILE  
STA 6+50 TO STA 11+50 (VISTA VIEW DR)  
STA 24+00 TO STA 24+71 (ALTA VISTA DR)

SCALE: 1"=20'

P.N. 16-03632  
C.O. 4926

SHEET:  
10 OF 16

- NOTES:
1. CONTRACTOR TO EXPOSE ENTIRE EX. METER BOX AND SETTER FOR DISTRICT CONNECTIONS.
  2. CONTRACTOR TO POT HOLE EX. TO ESTABLISH LINE AND GRADE FOR CONNECTIONS
  3. CONTRACTOR RESPONSIBLE FOR ALL EXCAVATION, SHORING, DEWATERING, TRAFFIC CONTROL, CONCRETE THRUST BLOCKING, BACKFILL, COMPACTION, AND SURFACE RESTORATION.
  4. ALL LONG SIDE CUSTOMER SERVICE LINES ARE TO BE MOLED/BORED.
  5. CONTRACTOR TO PROTECT EXISTING MAILBOXES.

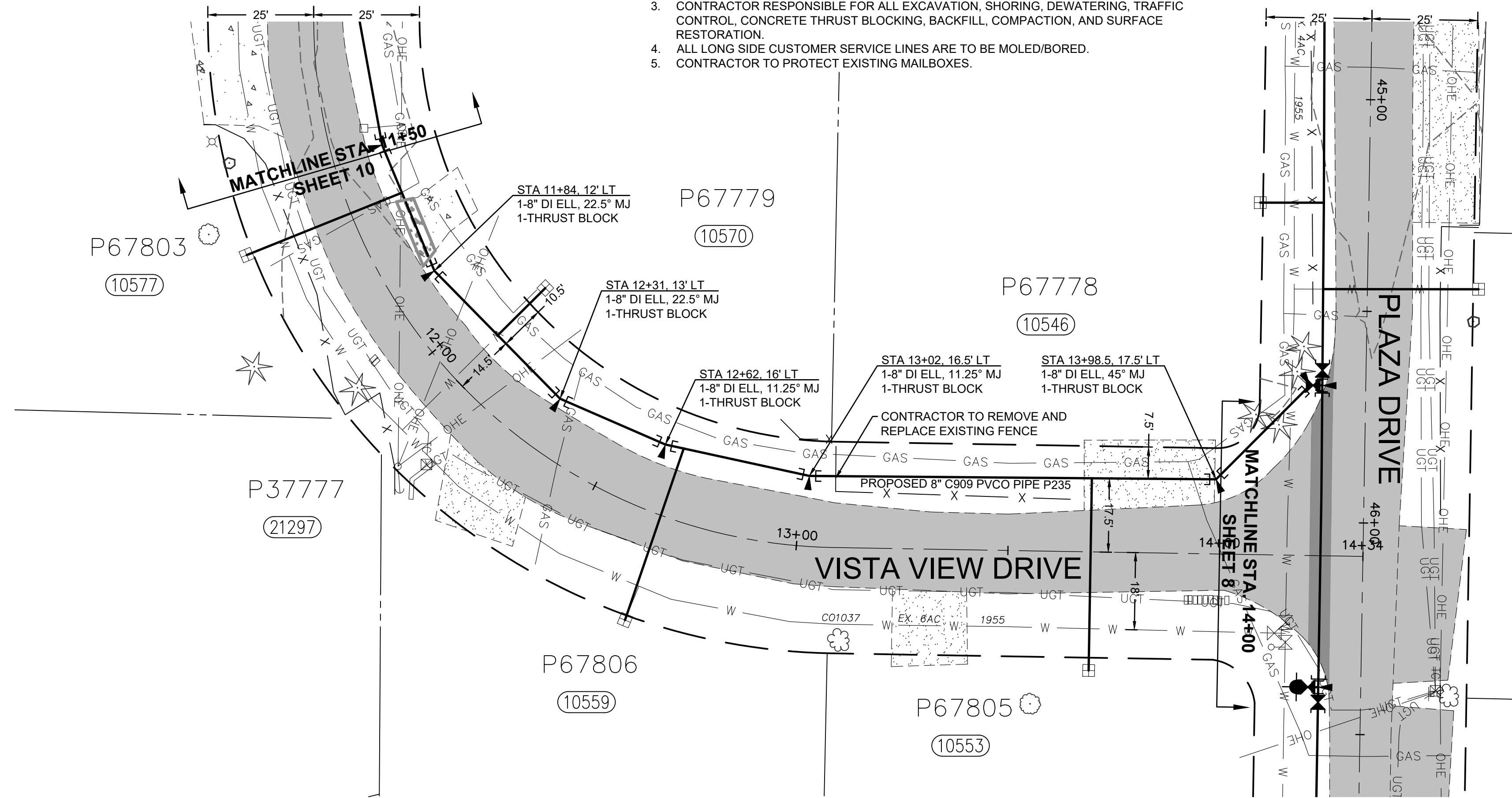

RENEW EX. SERVICES AT:	
STA	ADDRESS
11+62	10577 VISTA VIEW DR.
12+08	10570 VISTA VIEW DR.
12+67	10559 VISTA VIEW DR.
13+69	10553 VISTA VIEW DR.

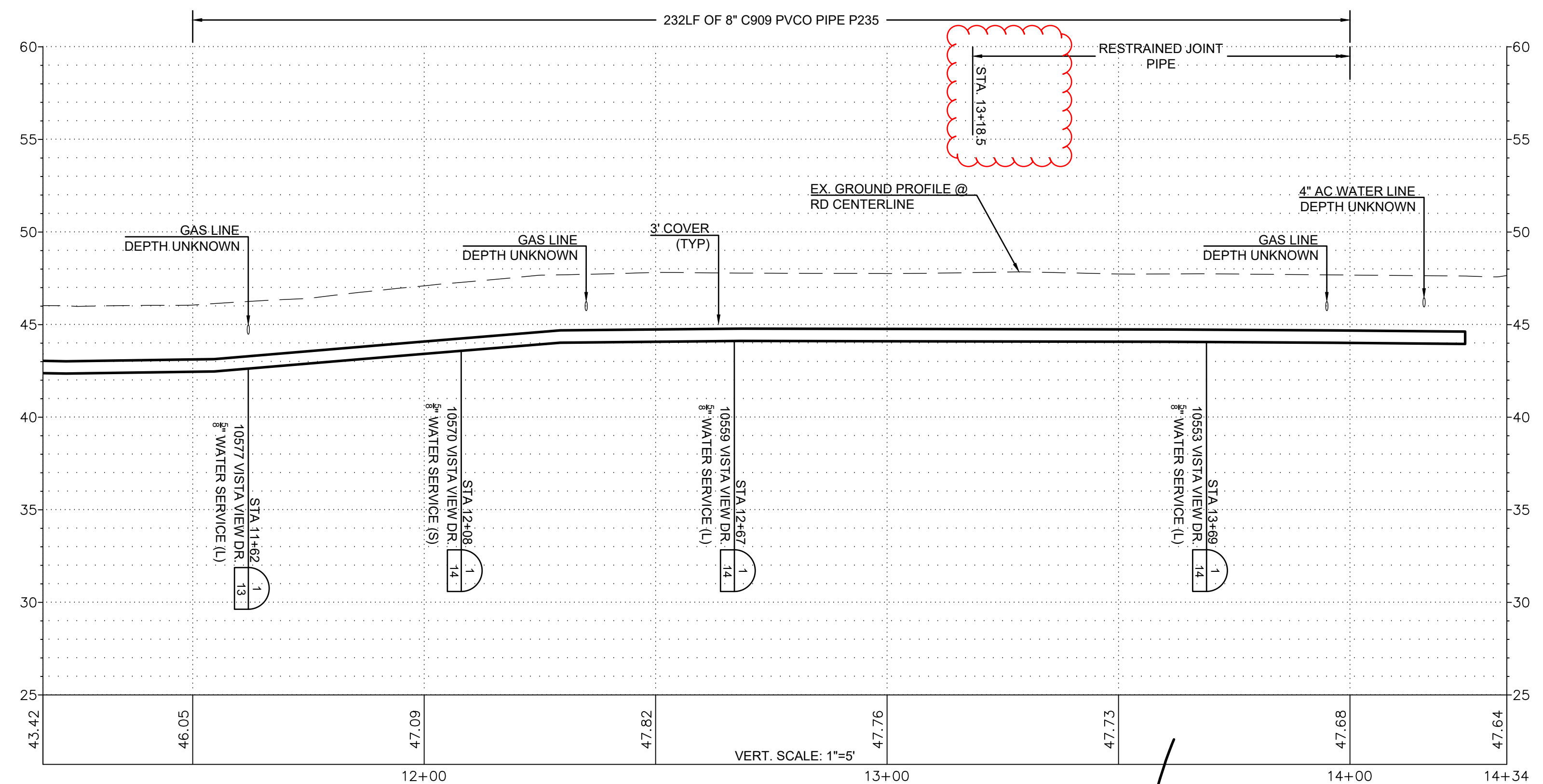

ISSUE	REVISIONS	BY	DATE
1.	30% DESIGN	MCH	4/25/16
2.	90% DESIGN	MCH	12/21/17
3.	ISSUED FOR BIDDING	MCH	7/29/25
4.	ADDENDUM #1	MCH	8/5/25

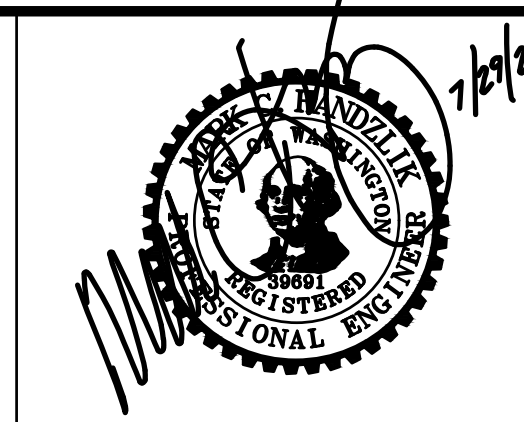

DATUM:  
HOR: NAD 83  
VERT: NAVD 88

DSGN BY: CAS  
DWN BY: JLB  
APPVD BY: MCH

DATE PRINTED: SEC: 27  
TWP: 35 N  
RGE: 4 E

**Skagit PUD**  
PUBLIC UTILITY DISTRICT  
1415 Freeway Drive  
P.O. BOX 1436  
Mount Vernon, WA 98273  
(360) 424-7104  
www.SkagitPud.org

ALTA VISTA, VISTA VIEW AND PLAZA DR.

VISTA VIEW  
PLAN AND PROFILE  
STA 11+50 TO STA 14+00

SCALE: 1"=20'

P.N. 16-03632	SHEET:
C.O. 4926	11 OF 16

- NOTES:
1. CONTRACTOR TO EXPOSE ENTIRE EX. METER BOX AND SETTER FOR DISTRICT CONNECTIONS.
  2. CONTRACTOR TO POT HOLE EX. TO ESTABLISH LINE AND GRADE FOR CONNECTIONS.
  3. CONTRACTOR RESPONSIBLE FOR ALL EXCAVATION, SHORING, DEWATERING, TRAFFIC CONTROL, CONCRETE THRUST BLOCKING, BACKFILL, COMPACTION, AND SURFACE RESTORATION.
  4. ALL LONG SIDE CUSTOMER SERVICE LINES ARE TO BE MOLED/BORED.
  5. CONTRACTOR TO PROTECT EXISTING MAILBOXES.

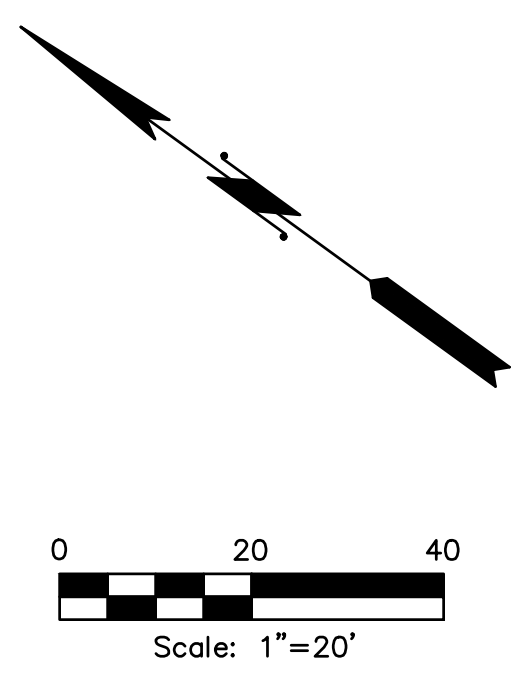
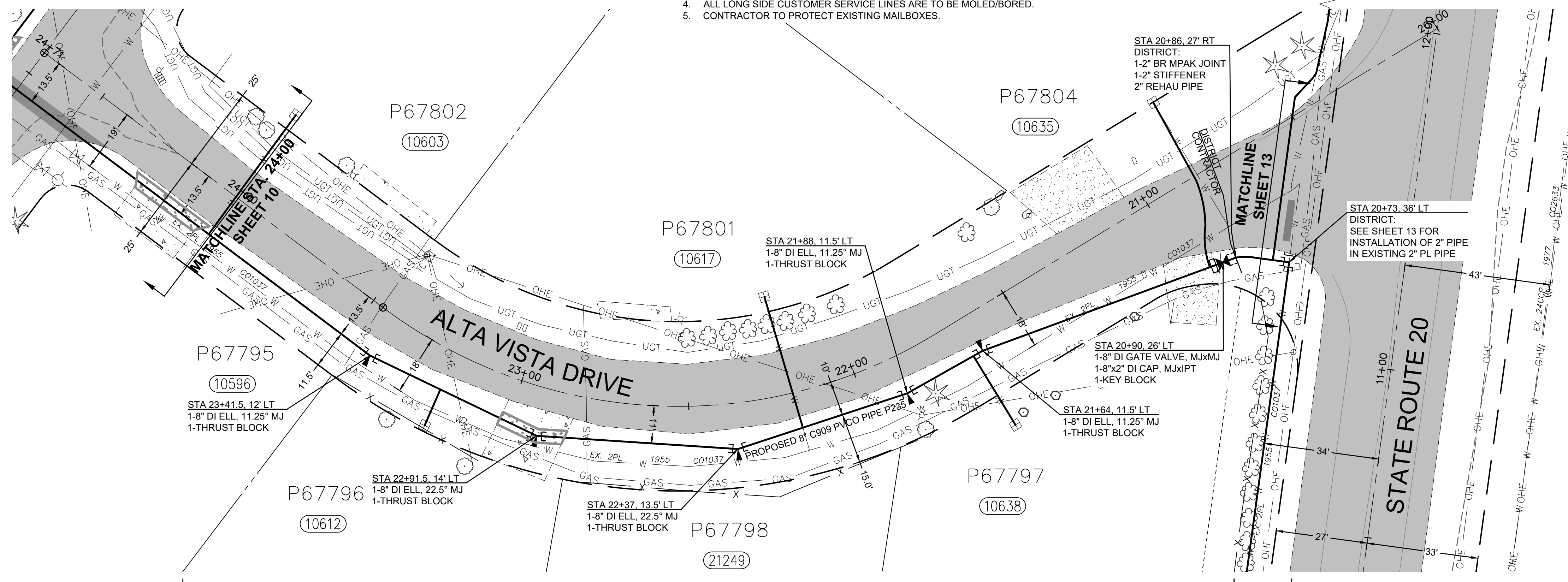

RENEW EX. SERVICES AT:	
STA	ADDRESS
23+20	10612 ALTA VISTA DR.
22+19	10617 ALTA VISTA DR.
21+67	10638 ALTA VISTA DR.
20+93	10635 ALTA VISTA DR.

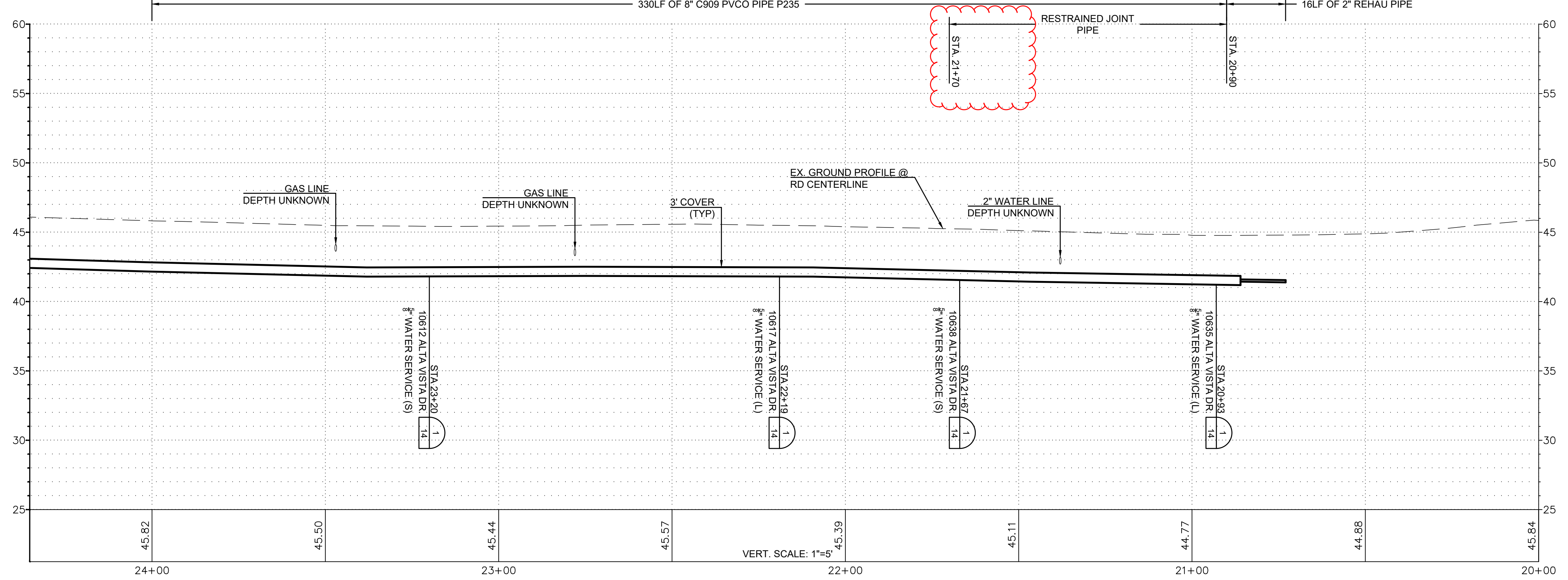

ISSUE	REVISIONS	BY	DATE
1.	30% DESIGN	MCH	4/25/16
2.	90% DESIGN	MCH	12/21/17
3.	ISSUED FOR BIDDING	MCH	7/29/25
4.	ADDENDUM #1	MCH	8/5/25



DATUM:	DSGN BY: CAS
HOR: NAD 83	DWN BY: JLB
VERT: NAVD 88	APPVD BY: MCH
DATE PRINTED:	SEC: 27
	TWP: 35 N
	RGE: 4 E



PUBLIC UTILITY DISTRICT  
NO. 1 of SKAGIT COUNTY  
1415 Freeway Drive  
P.O. BOX 1436  
Mount Vernon, WA 98273  
(360) 424-7104  
www.SkagitPud.org

ALTA VISTA, VISTA VIEW AND PLAZA DR.	
VISTA VIEW PLAN AND PROFILE STA 24+00 TO STA 20+00	
SCALE: 1"=20'	P.N. 16-03632
	SHEET: 12 OF 16